



MICHIGAN STAINED GLASS CENSUS FORM A: Building Data and Location of Windows

(Please type or print in black ink.)

Date: 11-20-97

Census Taker: HELEN GAGERN

Organization (if applicable): EMMANUEL LUTHERAN CHURCH

Address of Census Taker: 22401 ALEXANDRINE DEARBORN MI 48124
number street city state zip code

County: WAYNE Telephone (313) 562-6834 or (313) 565-4002

No. of slides included: 12 No. of photos - No. of negatives -
(Remember to include slide or photo of building exterior)

SKETCH OF BUILDING FLOOR PLAN: (Locate and number each window on plan. See Page 3 of instructions)

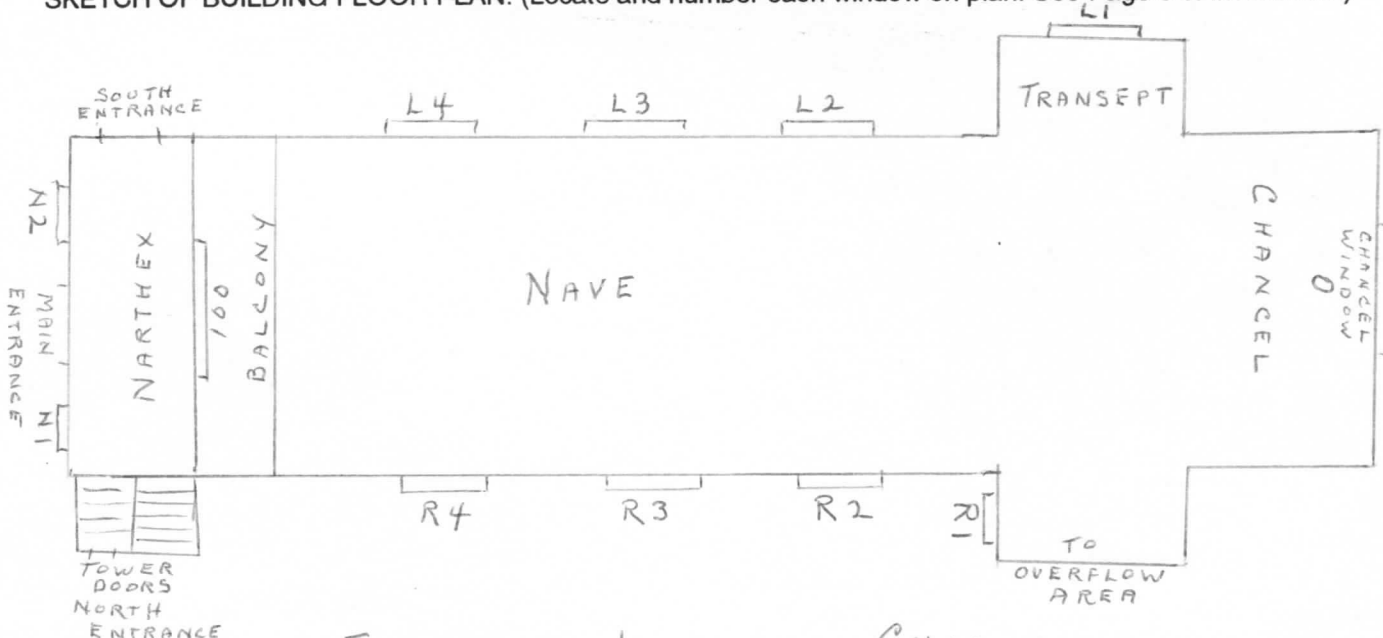

Name of Building: EMMANUEL LUTHERAN CHURCH

Function or type of Building: CHURCH BLDG.

Address of Building: 800 S. MILITARY DEARBORN MI 48124
number street city state zip code

Contact Person, Title: REV. JOEL R. BASELEY PASTOR Telephone: (313) 565-4002

Date of Construction: 1958-1959 Architect, city: MERRITT & COLE DETROIT, MI.

Dates of Alterations: - Architect, city: -

No. of pictorial windows: _____ No. of non-pictorial windows _____
(including figural, scenic, symbolic, historic, humanitarian, etc.)

Archival sources for building information: _____