

MICHIGAN STAINED GLASS CENSUS FORM A: Building Data and Location of Windows

(Please type or print in black ink.)

Date: 3/01/97

Census Taker: TENNEY BRINKMAN

Organization (if applicable): _____

Address of Census Taker: 2516 SOMERSET BLVD TROY MI 48084
number street city state zip code

County: OAKLAND Telephone (810) 649-4092 or (____) _____

No. of slides included: 2 No. of photos _____ No. of negatives _____
(Remember to include slide or photo of building exterior)

SKETCH OF BUILDING FLOOR PLAN: (Locate and number each window on plan. See Page 3 of instructions)

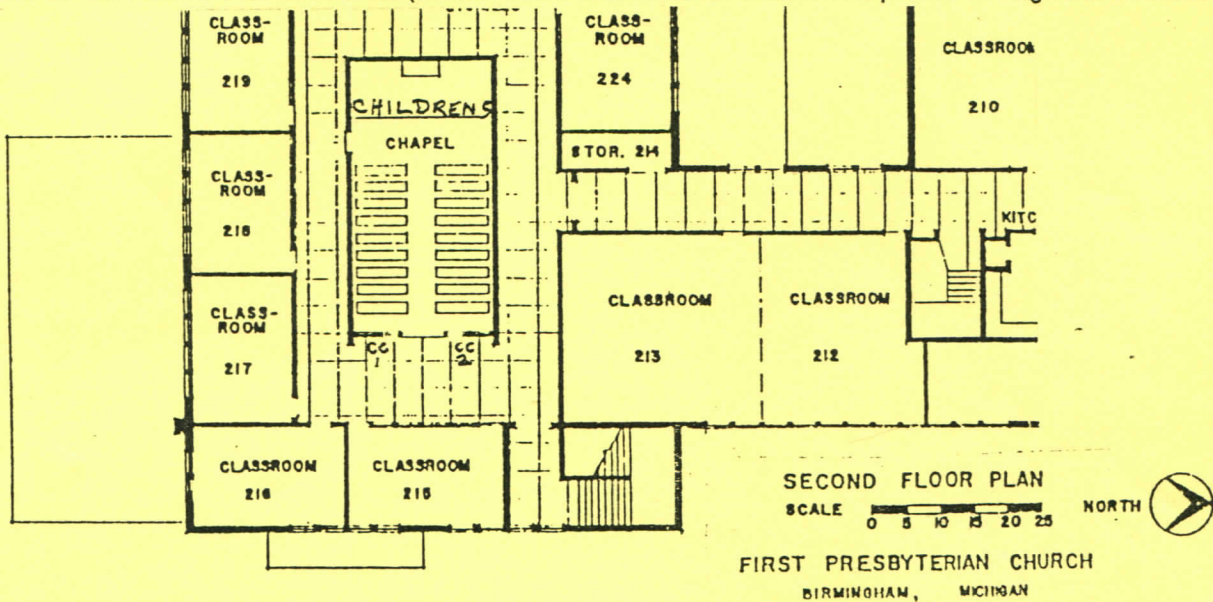

Name of Building: FIRST PRESBYTERIAN CHURCH

Function or type of Building: CHURCH

Address of Building: 1669 W. MAPLE ROAD BIRMINGHAM MI 48009
number street city state zip code

Contact Person, Title: TENNEY BRINKMAN, ARCHIVIST RONALD F. BYARS, PASTOR
Telephone: (810) 649-4092 CHURCH: 810 644-2040

Date of Construction: MAY, 1952 - MARCH 1954 Architect, city: HAROLD H. FISHER, AIA

Dates of Alterations: 1960, 1966 Architect, city: 1960: HAROLD H. FISHER AIA 1966: LINN SMITH A.I.A.
BIRMINGHAM, MI

No. of pictorial windows: 50 No. of non-pictorial windows: —
(including figural, scenic, symbolic, historic, humanitarian, etc.)

Archival sources for building information: THE ARCHIVES OF FIRST PRESBYTERIAN CHURCH:

3/5/72 "HISTORY OF F.P.C. AND ITS GROWTH UNDER DR HARRIS' PASTORATE"; ARCHITECTURAL DRAWINGS,

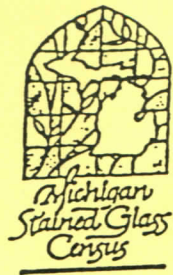

MICHIGAN STAINED GLASS CENSUS FORM A: Building Data and Location of Windows

(Please type or print in black ink.) Date: 5/01/97

Census Taker: TENNEY BRINKMAN / ART HELD / IRV POSTON
ARCHIVIST ARCHITECT PHOTOGRAPHER

Organization (if applicable): MEMBERS, FIRST PRESBYTERIAN CHURCH
#103

Address of Census Taker: 2516 SOMERSET BLVD TROY MI 48084
number street city state zip code

County: OAKLAND Telephone (810) 649-4092 or ()

No. of slides included: 13 No. of photos _____ No. of negatives _____
(Remember to include slide or photo of building exterior)

SKETCH OF BUILDING FLOOR PLAN: (Locate and number each window on plan. See Page 3 of instructions)

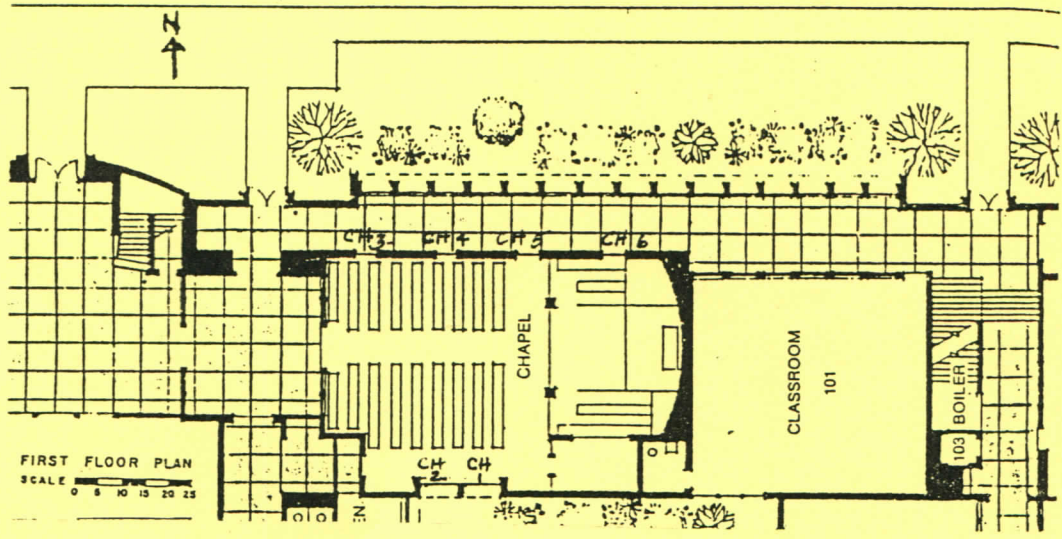

Name of Building: FIRST PRESBYTERIAN CHURCH

Function or type of Building: CHURCH

Address of Building: 1669 W. MAPLE ROAD BIRMINGHAM MI 48009
number street city state zip code

Contact Person, Title: TENNEY BRINKMAN, ARCHIVIST PASTOR RONALD P. BYARS
Telephone: (810) 644-2040 CHURCH: (810) 649-4092

Date of Construction: MAY 1952 - MARCH 1954 Architect, city: HAROLD H. FISHER, AIA

Dates of Alterations: 1960, 1966 Architect, city: 1960: HAROLD H. FISHER AIA 1966: LINN SMITH A.I.A.
BIRMINGHAM, MI

No. of pictorial windows: 50 No. of non-pictorial windows _____
(including figural, scenic, symbolic, historic, humanitarian, etc.)

Archival sources for building information: THE ARCHIVES OF FIRST PRESBYTERIAN CHURCH:

3/5/72 "HISTORY OF F.P.C. AND ITS GROWTH UNDER DR HARRIS' PASTORATE", ARCHITECTURAL DRAWINGS,
DONOR BOOK

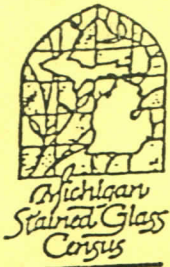

MICHIGAN STAINED GLASS CENSUS FORM A: Building Data and Location of Windows

(Please type or print in black ink.)

Date: 5/01/97

Census Taker: TENNEY BRINKMAN / ART HELD / TRV POSTON
ARCHIVES ARCHITECT PHOTOGRAPHER

Organization (if applicable): MEMBERS - FIRST PRESBYTERIAN CHURCH
#103

Address of Census Taker: 2516 SOMERSET BLVD TROY MI 48084
number street city state zip code

County: OAKLAND Telephone (810) 649-4092 or ()

No. of slides included: 20 No. of photos _____ No. of negatives _____
(Remember to include slide or photo of building exterior)

SKETCH OF BUILDING FLOOR PLAN: (Locate and number each window on plan. See Page 3 of instructions)

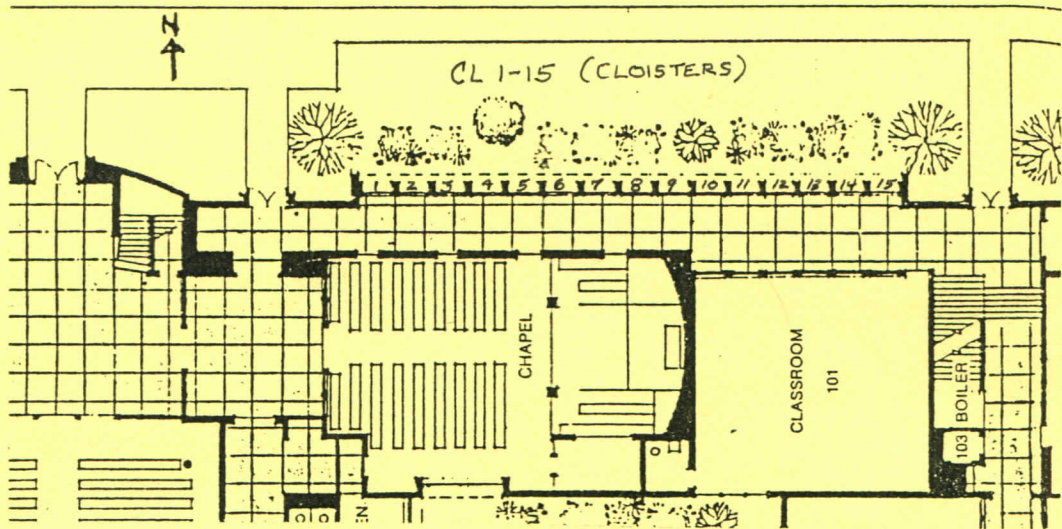

Name of Building: FIRST PRESBYTERIAN CHURCH

Function or type of Building: CHURCH

Address of Building: 1669 W. MAPLE ROAD BIRMINGHAM MI 48009
number street city state zip code

Contact Person, Title: RONALD P. BYARS, PASTOR TENNEY BRINKMAN, ARCHIVIST
CHURCH: 810 644-2040 Telephone: (810) 649-4092

Date of Construction: MAY 1952 - MARCH 1954 Architect, city: HAROLD H. FISHER, AIA

Dates of Alterations: 1960, 1966 Architect, city: 1960: HAROLD H. FISHER AIA 1966: LINN SMITH A.I.A.
BIRMINGHAM, MI

No. of pictorial windows: 50 No. of non-pictorial windows —
(including figural, scenic, symbolic, historic, humanitarian, etc.)

Archival sources for building information: THE ARCHIVES OF FIRST PRESBYTERIAN CHURCH:

3/5/72 "HISTORY OF F.P.C. AND ITS GROWTH UNDER DR HARRIS' PASTORATE"; ARCHITECTURAL DRAWINGS,

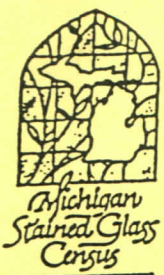

MICHIGAN STAINED GLASS CENSUS FORM A: Building Data and Location of Windows

(Please type or print in black ink.) Date: 5/6/97

Census Taker: TENNEY BRINKMAN / IRV POSTON / ART HELD
ARCHIVIST PHOTOGRAPHER ARCHITECT

Organization (if applicable): MEMBERS: FIRST PRESBYTERIAN CHURCH
#103

Address of Census Taker: 2516 SOMERSET BLVD TROY MI 48084
number street city state zip code

County: OAKLAND Telephone (810) 649-4092 or ()

No. of slides included: 16 No. of photos _____ No. of negatives _____
 (Remember to include slide or photo of building exterior)

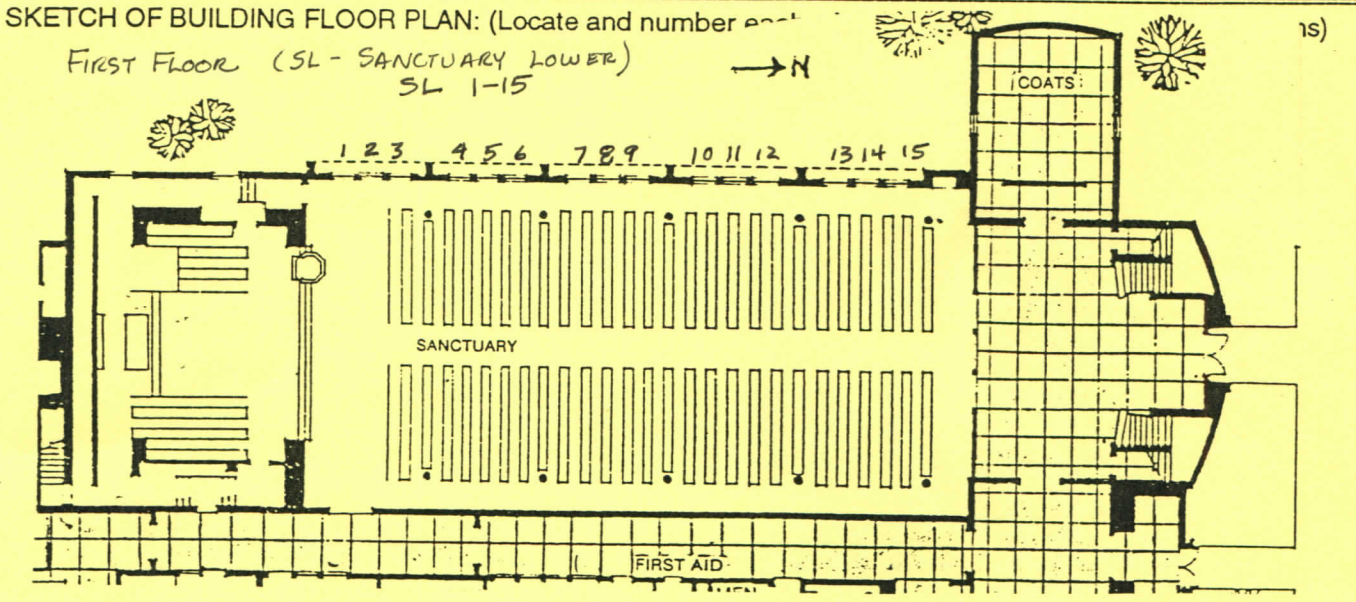

Name of Building: FIRST PRESBYTERIAN CHURCH

Function or type of Building: CHURCH

Address of Building: 1669 W. MAPLE ROAD BIRMINGHAM MI 48009
number street city state zip code

Contact Person, Title: TENNEY BRINKMAN, ARCHIVIST RONALD P. BYARS, PASTOR
 Telephone: (810) 649-4092 CHURCH: 810 644-2040

Date of Construction: MAY, 1952 - MARCH 1954 Architect, city: HAROLD H. FISHER, AIA

Dates of Alterations: 1960, 1966 Architect, city: 1960: HAROLD H. FISHER AIA 1966: LINN SMITH A.I.A.
BIRMINGHAM, MI

No. of pictorial windows: 50 No. of non-pictorial windows —
 (including figural, scenic, symbolic, historic, humanitarian, etc.)

Archival sources for building information: THE ARCHIVES OF FIRST PRESBYTERIAN CHURCH:
3/5/72 "HISTORY OF F.P.C. AND ITS GROWTH UNDER DR HARRIS' PASTORATE"; ARCHITECTURAL DRAWINGS,
DONOR BOOK

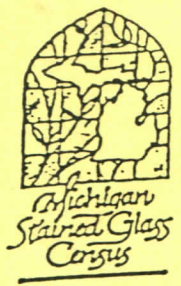

MICHIGAN STAINED GLASS CENSUS FORM A: Building Data and Location of Windows

(Please type or print in black ink.) Date: 5/01/97

Census Taker: TENNEY BRINKMAN / ART HELD / IRV POSTON
ARCHIVES ARCHITECT PHOTOGRAPHER

Organization (if applicable): MEMBERS: FIRST PRESBYTERIAN CHURCH
#103

Address of Census Taker: 2516 SOMERSET BLVD TROY MI 48084
number street city state zip code

County: OAKLAND Telephone (810) 649-4092 or ()

No. of slides included: 24 No. of photos _____ No. of negatives _____
(Remember to include slide or photo of building exterior)

SKETCH OF BUILDING FLOOR PLAN: (Locate and number each window on plan. See Page 3 of instructions)

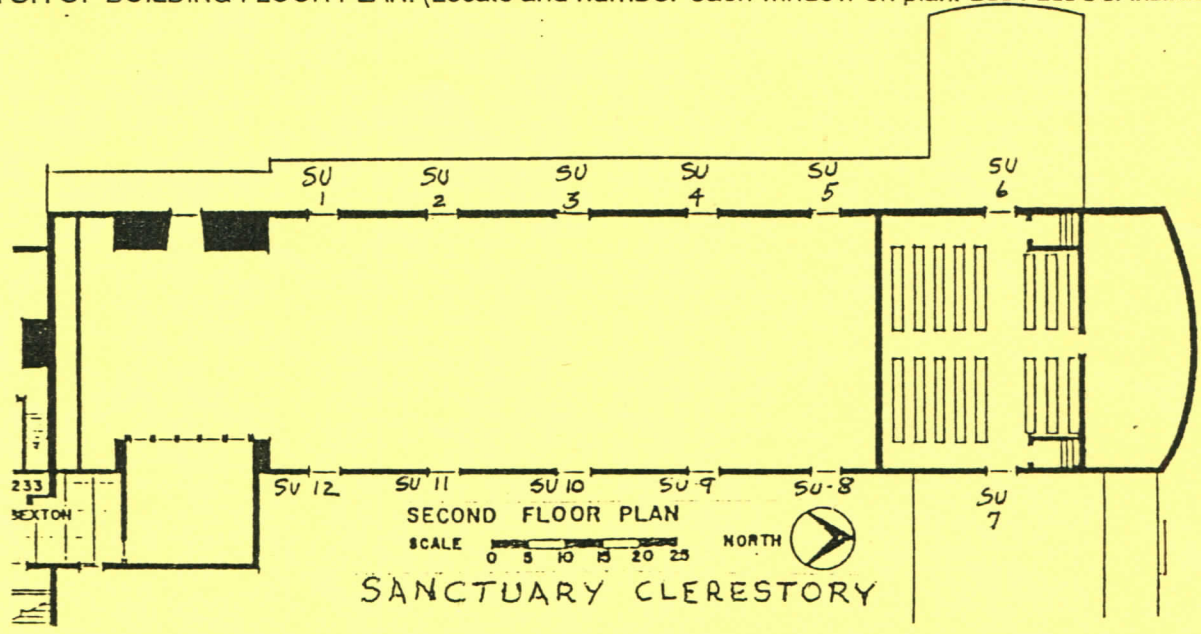

Name of Building: FIRST PRESBYTERIAN CHURCH

Function or type of Building: CHURCH

Address of Building: 1669 W. MAPLE ROAD BIRMINGHAM MI 48009
number street city state zip code

Contact Person, Title: TENNEY BRINKMAN, ARCHIVIST Telephone: (810) 649-4092
RONALD F. BYARS, PASTOR CHURCH: 810 644-2040

Date of Construction: MAY, 1952 - MARCH 1954 Architect, city: HAROLD H. FISHER, AIA

Dates of Alterations: 1960, 1966 Architect, city: 1960: HAROLD H. FISHER AIA 1966: LINN SMITH AIA
BIRMINGHAM, MI

No. of pictorial windows: 50 No. of non-pictorial windows: —
(including figural, scenic, symbolic, historic, humanitarian, etc.)

Archival sources for building information: THE ARCHIVES OF FIRST PRESBYTERIAN CHURCH:

3/5/72 "HISTORY OF F.P.C. AND ITS GROWTH UNDER DR HARRIS' PASTORATE"; ARCHITECTURAL DRAWINGS, DONOR BOOK