



MICHIGAN STAINED GLASS CENSUS FORM A: Building Data and Location of Windows

(Please type or print in black ink.)

Date: JANUARY 21, 1997

Census Taker: CAROLYN DRESCHER

Organization (if applicable): WEST BLOOMFIELD UNITED METHODIST CH.

Address of Census Taker: 4100 WALNUT LAKE RD. W. BLOOMFIELD, MI. 48323
number street city state zip code

County: DAKLAND Telephone (810) 851-2330 or (810) 851-5602

No. of slides included: — No. of photos 1 No. of negatives —
(Remember to include slide or photo of building exterior)

SKETCH OF BUILDING FLOOR PLAN: (Locate and number each window on plan. See Page 3 of instructions)

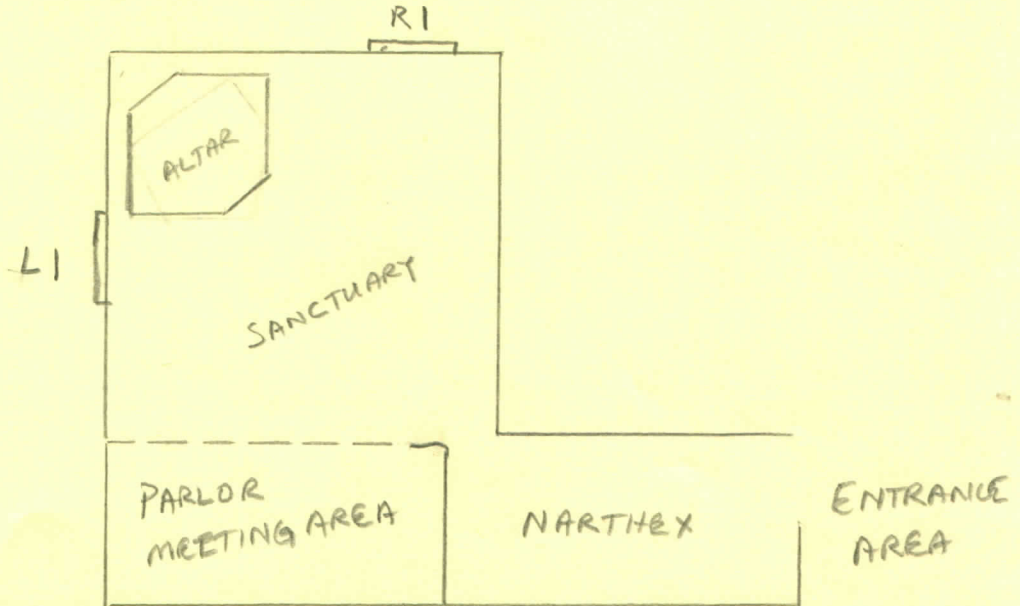

Name of Building: WEST BLOOMFIELD U.M. CHURCH

Function or type of Building: CHURCH

Address of Building: 4100 WALNUT LAKE RD. W. BLOOMFIELD MI. 48323
number street city state zip code

Contact Person, Title: REV. JEROME SMITH, PASTOR Telephone: (810) 851-2330
FARMINGTON

Date of Construction: 1980 Architect, city: MERRITT, COLE, + McCALLUM

Dates of Alterations: 1991 Architect, city: MMA ASSOCIATES, ROCHESTER
(MICHAEL MELDRUM)

No. of pictorial windows: 2 No. of non-pictorial windows 0
(including figural, scenic, symbolic, historic, humanitarian, etc.)

Archival sources for building information: CONSECRATION SERVICE BULLETIN,
OCTOBER 11, 1981