



MICHIGAN STAINED GLASS CENSUS FORM A: Building Data and Location of Windows

(Please type or print in black ink.)

Date: DEC 8, 1996

Census Taker: TOM WIDEMAN

Organization (if applicable): _____

Address of Census Taker: 142 E. CENTER ITHACA MI 48847
number street city state zip code

County: GRATIOT Telephone (517) 8754544 or (____) _____

No. of slides included: 11 No. of photos — No. of negatives —
(Remember to include slide or photo of building exterior)

SKETCH OF BUILDING FLOOR PLAN: (Locate and number each window on plan. See Page 3 of instructions)

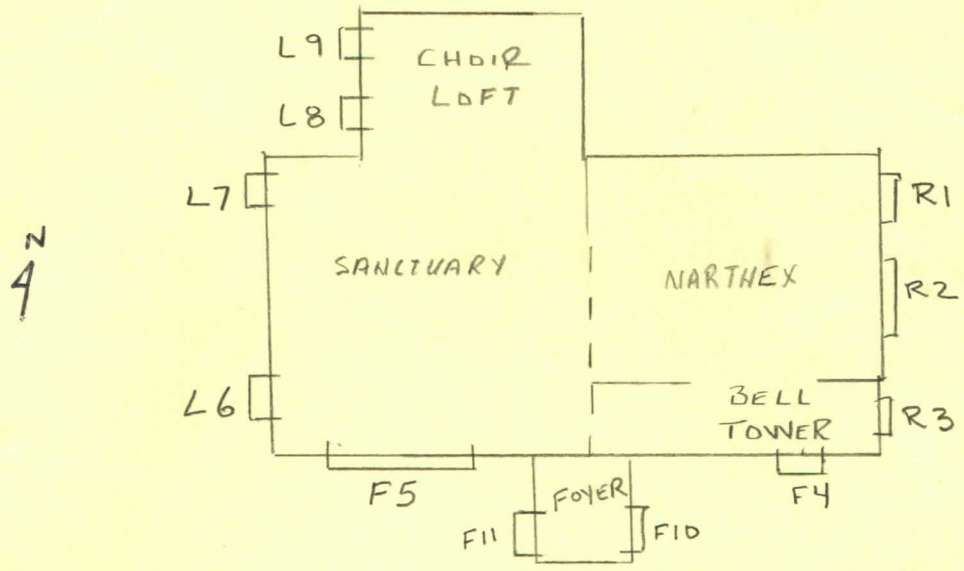

Name of Building: ITHACA UNITED METHODIST CHURCH

Function or type of Building: CHURCH

Address of Building: 327 EAST CENTER ITHACA MI 48847
number street city state zip code

Contact Person, Title: REV. DAVID L. MCBRIDE Telephone: (517) 8754313

Date of Construction: 1865 Architect, city: _____

Dates of Alterations: _____ Architect, city: _____

No. of pictorial windows: — No. of non-pictorial windows 11
(including figural, scenic, symbolic, historic, humanitarian, etc.)

Archival sources for building information: CHURCH HISTORY "1965" 100 YEARS.