



For office use
MSGC# 95.0054

Michigan Stained Glass Census FORM A: Building Data and Location of Windows

(Please type or print in black ink.)

Date: 10/15/92

Census Taker: Barbara Krueger

Organization: _____

Address: 4450 Fenton Rd Hartland Mi
number street city zip

County: Oakland Telephone: (313) 887-1283

No. of slides included: 18 No. of photos: _____ Time spent on survey: _____

BUILDING SKETCH PLAN

Oakland county

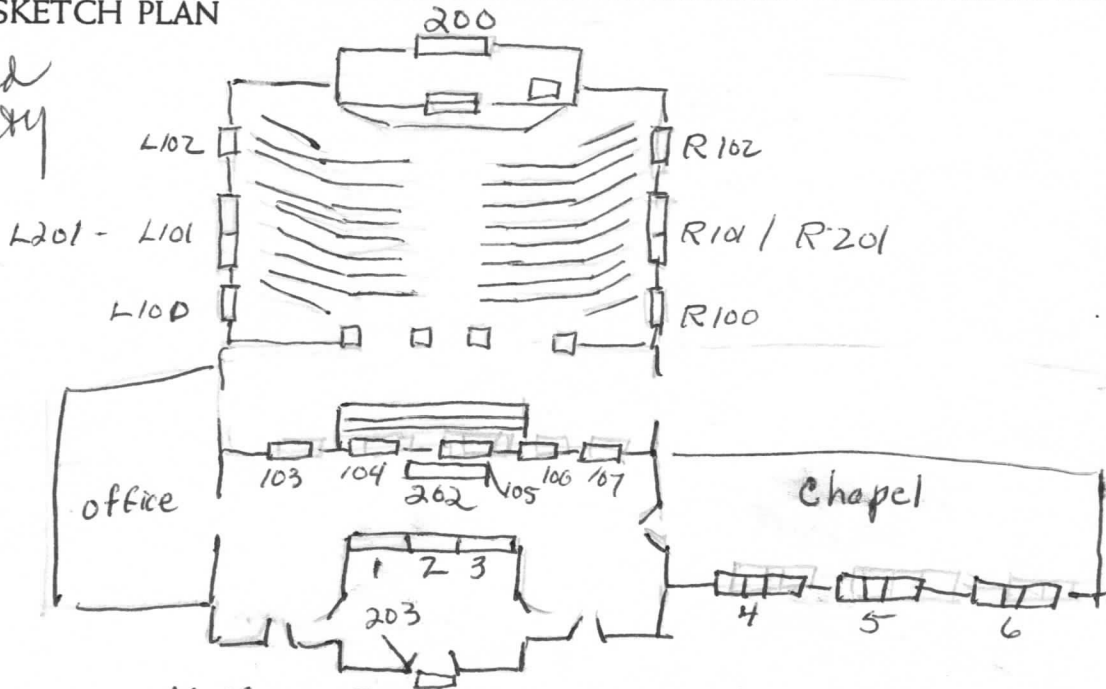

Name of Building: Milford Presbyterian Church

Function or type: _____

Address: 238 N. Main Milford
number street city

Contact Person, Title: _____ Phone: (313) 684-2805 zip

Date of construction: 1899/1900 Architect, city: _____

Dates of alteration: _____ Architect, city: _____

No. of figural windows 3 No. of ornamental windows: 19
(including scenic, symbolic, historic, humanitarian, etc.)

Archival sources for building information: Milford Times 10-14-1899, 10-28-1899, 11-18-1899, 4-21-1899, 4-21-1900 (dedication) 1-15-1966 (chapel addition)

Burton - Archives of Detroit Stained Glass